

Microsoft Entra ID Account Integration

Navigating to the Integrations Page

- **Log in to the Platform**
 - Access the platform and sign in using your credentials.
- **Open the Integrations Section**
 - Locate the side navigation panel on the left.
 - Click on the **Integrations** tab.
- **Select Microsoft Integration**
 - On the Integrations page, you will see available options for **AWS, Azure, and Microsoft accounts**.
 - Click on the **Microsoft card** then click on **M365** to open the “Link a New Microsoft Account” page.

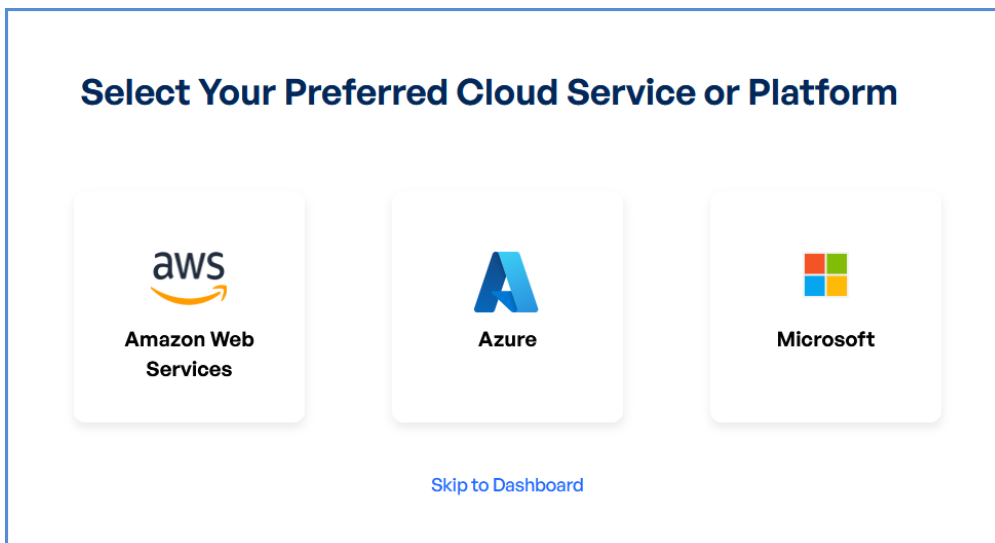

Initiating Entra ID Integration

Registering an Application and configuration in Microsoft Entra Admin center

- Navigate to the **Microsoft Entra Admin Center Portal**.
- In the search bar, enter **App Registrations** and select it from the results.

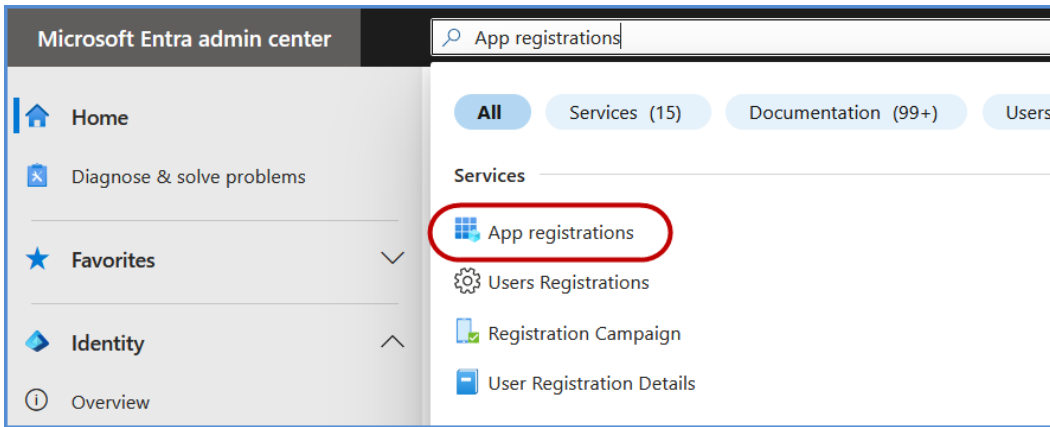

- Click on **New Registration**.
- Register the application:
 - Provide a name for the application.
 - Under **Supported account types**, select **Accounts in this organizational directory only** if not set by default.
 - Click **Register** to complete the process.

Register an application

*** Name**

The user-facing display name for this application (this can be changed later).

 ✓

Supported account types

Who can use this application or access this API?

- Accounts in this organizational directory only (Axiom365 only - Single tenant)
- Accounts in any organizational directory (Any Microsoft Entra ID tenant - Multitenant)
- Accounts in any organizational directory (Any Microsoft Entra ID tenant - Multitenant) and personal Microsoft accounts (e.g. Skype, Xbox)
- Personal Microsoft accounts only

[Help me choose...](#)

Redirect URI (optional)

We'll return the authentication response to this URI after successfully authenticating the user. Providing this now is optional and it can be changed later, but a value is required for most authentication scenarios.

By proceeding, you agree to the [Microsoft Platform Policies](#)

Register

- Navigate to **Manage** and click on **API Permissions**.
- Click on **Add a permission**.

Home > App registrations > Xops-App

Xops-App | API permissions

Search Refresh Got feedback?

- Overview
- Quickstart
- Integration assistant
- Diagnose and solve problems
- Manage
 - Branding & properties
 - Authentication
 - Certificates & secrets
 - Token configuration
 - API permissions**
 - Expose an API
 - App roles
 - Owners

Granting tenant-wide consent may revoke permissions that have already been granted to

The "Admin consent required" column shows the default value for an organization. How organizations where this app will be used. [Learn more](#)

Configured permissions

Applications are authorized to call APIs when they are granted permissions by users/admins. All the permissions the application needs. [Learn more about permissions and consent](#)

+ Add a permission ✓ Grant admin consent for aiotestlab

API / Permissions name	Type	Description
Microsoft Graph (1)		
User.Read	Delegated	Sign in and read user profile

- Select **Microsoft APIs** and click on **Microsoft Graph**.

Request API permissions

Select an API

Microsoft APIs APIs my organization uses My APIs

Commonly used Microsoft APIs



Microsoft Graph
Take advantage of the tremendous amount of data in Office 365, Enterprise Mobility + Security, and Windows 10. Access Microsoft Entra ID, Excel, Intune, Outlook/Exchange, OneDrive, OneNote, SharePoint, Planner, and more through a single endpoint.

- Choose **Application permissions**, search for **AccessReview.Read.All**, select it, and click **Add permissions**.

Request API permissions



< All APIs



Microsoft Graph

<https://graph.microsoft.com/> [Docs](#)

What type of permissions does your application require?

Delegated permissions

Your application needs to access the API as the signed-in user.

Application permissions

Your application runs as a background service or daemon without a signed-in user.

Select permissions

[expand all](#)

Permission

Admin consent required

AccessReview (1)



AccessReview.Read.All
Read all access reviews

Yes

Add permissions

Discard

- Click on **Grant admin consent** and confirm by selecting **Yes** in the confirmation popup.

Configured permissions

Applications are authorized to call APIs when they are granted permissions by users/admins as part of the consent process. The list of configured permissions should include all the permissions the application needs. [Learn more about permissions and consent](#)

+ Add a permission Grant admin consent for aiotestlab

API / Permissions name	Type	Description	Admin consent requ...	Status
Microsoft Graph (1)				
AccessReview.Read.All	Application	Read all access reviews	Yes	⚠ Not granted for aiotestl... ...

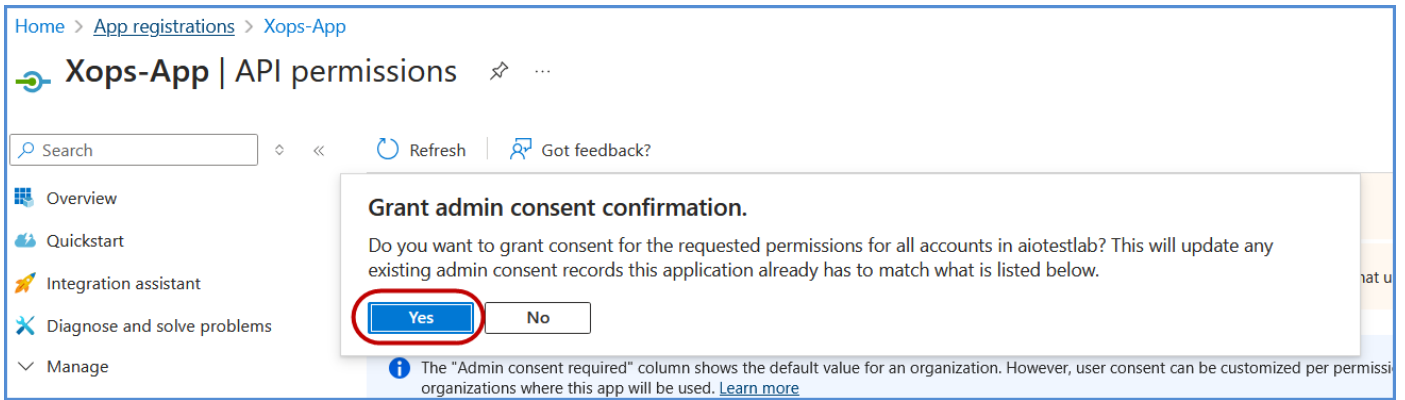

Assigning Entra ID Permissions

- In the **Azure Portal**, search for **Entra ID** and select it.

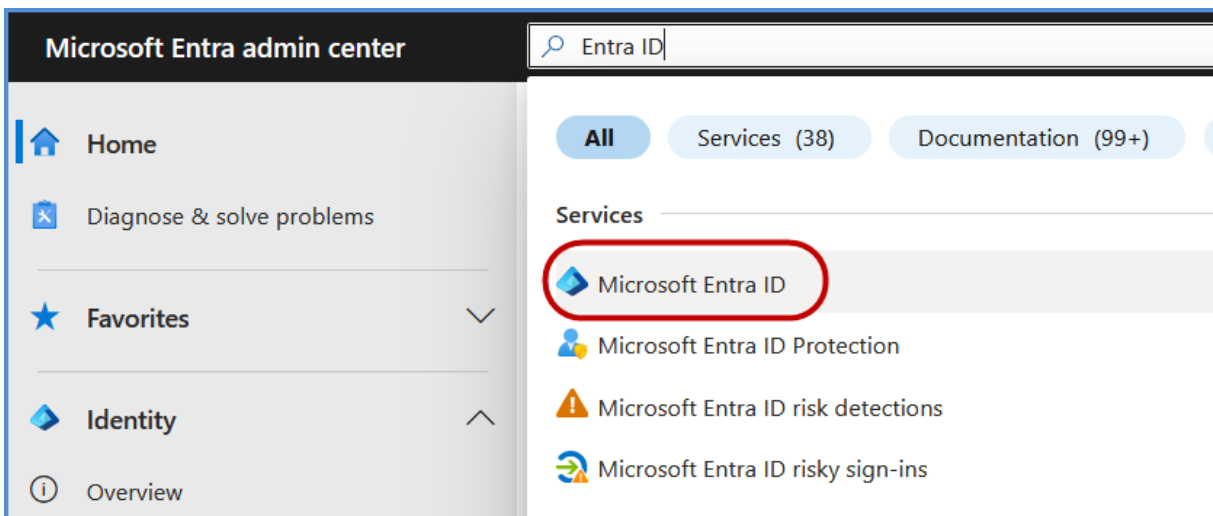

- Go to **Overview**, and in the left navigation pane, click **Roles and Administrators**.
- Search for **Global Reader** and select it.

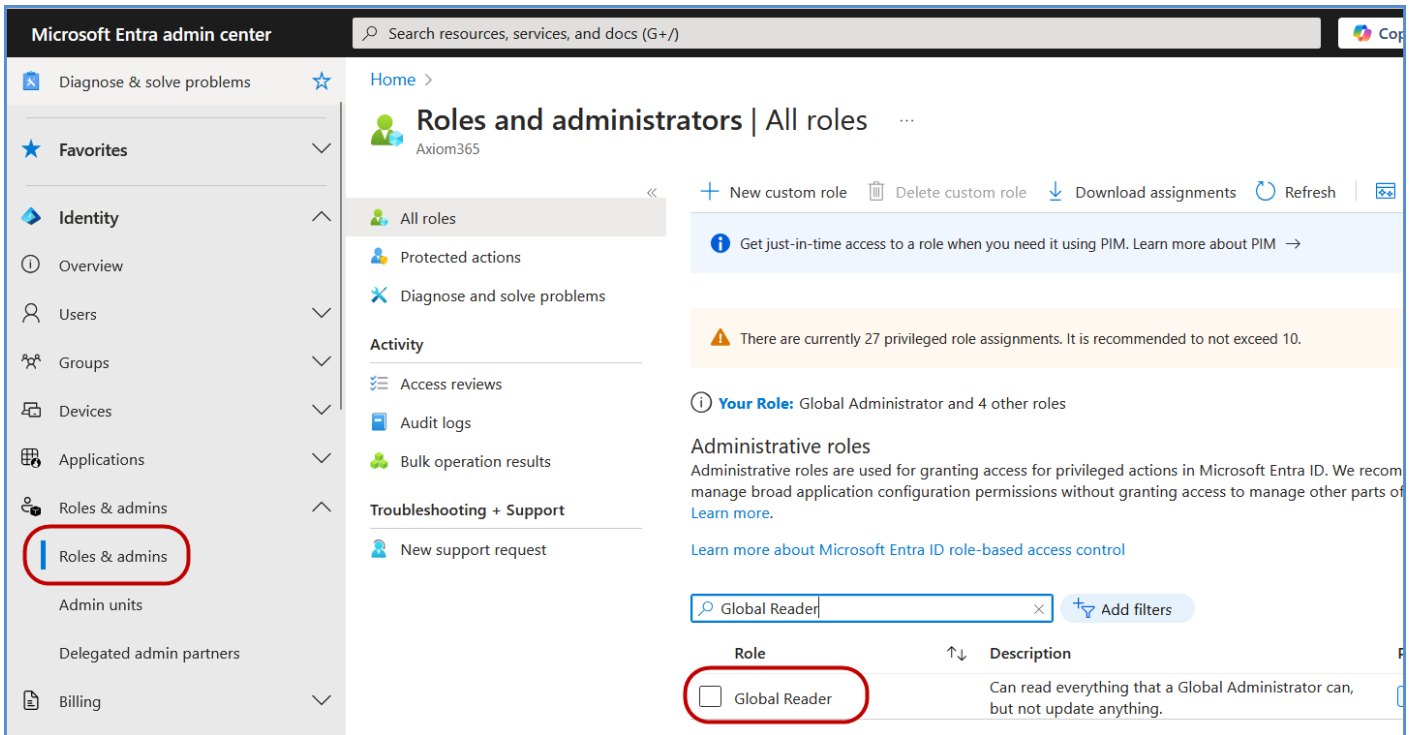

- Under **Assignments**, search for the application registered in the previous step, select it, and click **Add** to grant the **Global Reader** role to the application.

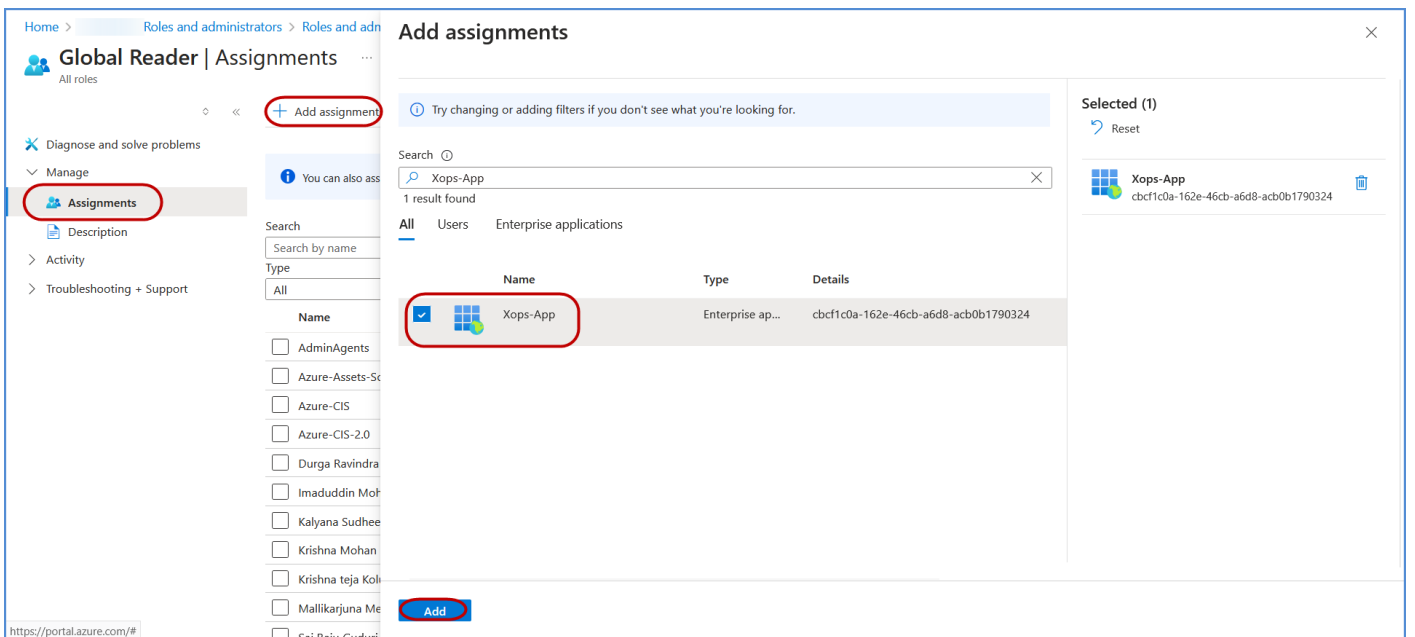

Adding a Certificate for Authentication

- Navigate to the previously created **Application Registration**.
- Copy the **Application (Client) ID** and **Directory (Tenant) ID**.
- Go to Domain names, copy the **Organization ID**
- Access the **Xops 360 Portal** and navigate to **Integrations** , Select **Microsoft** icon then click on **Add Account for Microsoft**.
- Enter a friendly name for the account.
- Provide the **App ID**, **Tenant ID** copied earlier.

- Click **Generate Public Key & Download** the generated key.

Link a new Microsoft Account

[Click here for detailed instructions on how to connect](#)

👤 Axiom - M365 ⓘ

👤 Tenant ID ⓘ

🔒 Application ID ⓘ

🔒 Organisation name ⓘ

Generate public key & Download

Note: This account will be added with read-only permissions

Connect

- Return to the **Microsoft Entra Admin center Portal**, open the application, and go to **Manage > Certificates & Secrets**.
- Click **Upload Certificate**, select the certificate file downloaded earlier, and click **Add** to complete the upload process.

Home > App registrations > Xops-App
Xops-App | Certificates & secrets

Search

- Overview
- Quickstart
- Integration assistant
- Diagnose and solve problems
- Manage
 - Branding & properties
 - Authentication
 - Certificates & secrets**
 - Token configuration
 - API permissions
 - Expose an API
 - App roles
 - Owners
 - Roles and administrators
 - Manifest
- Support + Troubleshooting

Credentials enable confidential applications to identify themselves to the authentication service when receiving token scheme). For a higher level of assurance, we recommend using a certificate (instead of a client secret) as a credential.

Application registration certificates, secrets and federated credentials can be found in the tabs below.

Certificates (0) Client secrets (0) Federated credentials (0)

Certificates can be used as secrets to prove the application's identity when requesting a token. Also can be referred

Upload certificate

Thumbprint	Description	Start date
No certificates have been added for this application.		

Upload certificate

Upload a certificate (public key) with one of the following file types: .cer, .pem, .crt *

Select a file

Description

Enter a description for this certificate

Add
Cancel

Note:

- For any challenges, please contact our support team at [**support@axiomio.com**](mailto:support@axiomio.com)
 - **First-Time Login Experience**
 - When you log in for the first time, you will be prompted to select your preferred **cloud service or platform** (AWS, Azure, or Microsoft). This selection is required to establish the initial account connection.
 - Once your account is successfully connected to AWS, Azure, or Microsoft, this selection screen **will not appear** in subsequent logins. Instead, you will be directed **automatically to the Home page**.
 - To manage or modify integrations, navigate to the **"Integrations"** section from the left panel in the dashboard.
-

Revision #11

Created 31 January 2025 18:38:46 by Axiom IO

Updated 19 September 2025 18:20:37 by Axiom IO